

**Portsmouth 5' Bench**  
(058)

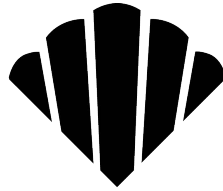

SEASIDE CASUAL

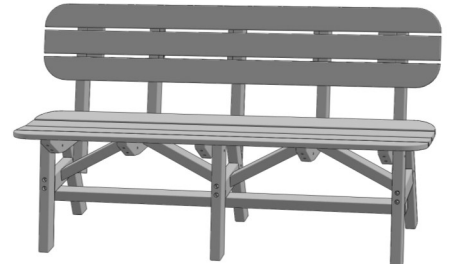

**ASSEMBLY INSTRUCTIONS**

**1**

**PLEASE READ INSTRUCTIONS COMPLETELY BEFORE BEGINNING.**  
Carefully remove contents from box. Make sure that all parts and hardware are included using the Parts List below.

**Tools Required:** 4mm Allen Wrench (included); #2 Phillips Head Screwdriver; Rubber Mallet.

**Back Assembly**

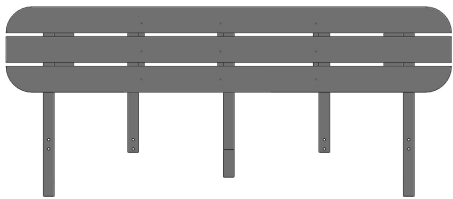

x 1

**Seat Assembly**

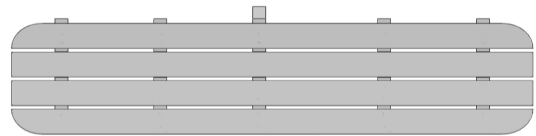

x 1

**Angle Brace**



x 4

**Leg Assembly**



x 3

**Lower Stretcher**



x 1

**80mm Hex Lag**

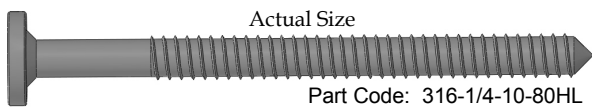

Part Code: 316-1/4-10-80HL

x 11

**4mm Allen Wrench**

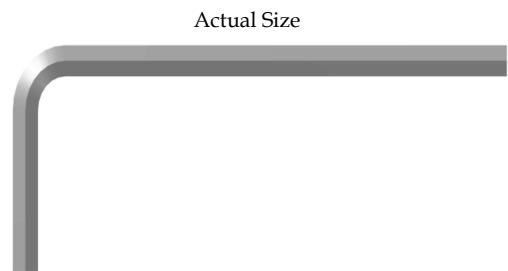

Part Code: 4MMALLEN

x 1

**90mm Connector Bolt**



Part Code: 316-1/4-20-90HB

x 9

**Bungs**

Actual Size



x 8

**Flat Washer, Lock Washer & Nut**

Actual Size



x 9ea

**1-3/4" Phillips Head Screw**

Actual Size



Part Code: 316-8X1-3/4PFDS

x 8

WARRANTY QUESTIONS OR COMMENTS PLEASE CALL TOLL FREE AT 1-800-809-3114

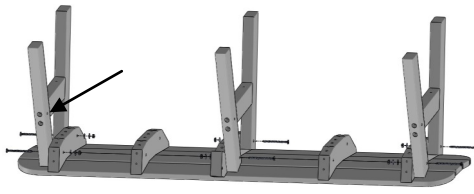
**2****ATTACH LEG ASSEMBLIES TO SEAT ASSEMBLY**

Align Leg Assemblies with Seat Supports

as shown, with the hole in the rear leg facing the rear of the seat. Secure using (6) 90mm Connector Bolts, Flat washers, Lock Washers, and Nuts.

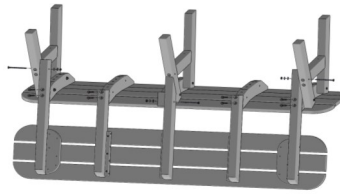
**3****ATTACH BACK ASSEMBLY**

Align Back Uprights with Legs and Seat Cleats. Secure long back

uprights with (2) 90mm Connector Bolts, Flat Washers, Lock Washers, and Nuts through holes in outer legs, and (1) 90mm Connector Bolt, Flat Washer, Lock Washer, and Nut through Mid Back Upright into Mid Seat Support. Then use (8) 80mm Hex lags through counter-bored holes in Back Uprights. Plug all Counter-bored holes with (8) 5/8" Bungs using a rubber mallet.

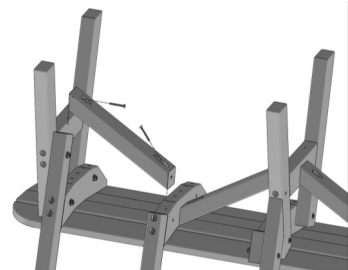
**4****ATTACH ANGLE BRACES**

Align Angle Braces with Leg Cleats and Seat Supports over second seat slat from rear as shown

with counter-bores facing away from seat. Secure using (8) 1-3/4" Phillips Head Screws.

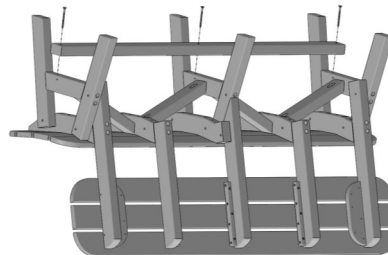
**5****ATTACH LOWER STRETCHER TO LEG ASSEMBLIES**

Align Lower Stretcher with pilot holes in Leg Cleats. Secure using

(3) 80mm Hex Lags.

**6**

**TIGHTEN ALL CONNECTIONS. AVOID OVER TIGHTENING; DOING SO CAN CAUSE DAMAGE TO THE PRODUCT.**